

# DTCM120 Series

Support 1/2"

Cameras



Lens Model	FOV (Φmm)	Mag. β(x)	WD (mm)	Sensor Size (Φmm)	F/#	MTF30 (lp/mm)	DOF (mm)	Distortion (% max)	Telecentricity (° max)	I/O (mm)	Length (mm)	Mount	Weight (kg)
DTCM120-26-AL	26	0.308	73±1	8.0(1/2")	4.2	>175	±4.6@F11	<0.1	<0.1	198±1	107.2	C	0.3
DTCM120-36-AL	36	0.222	110±2	8.0(1/2")	4.2	>190	±8.9@F11	<0.1	<0.1	255±2	127.2	C	0.4
DTCM120-42-AL	42	0.190	118±3	8.0(1/2")	4.2	>210	±12.1@F11	<0.1	<0.1	248±3	112.7	C	0.4
DTCM120-48-AL	48	0.167	128±3	8.0(1/2")	4.2	>200	±15.7@F11	<0.1	<0.1	272±3	126.2	C	0.4
DTCM120-56-AL	56	0.143	138±3	8.0(1/2")	4.2	>210	±21.5@F11	<0.1	<0.1	304±3	148.7	C	0.6
DTCM120-64H-AL	64	0.125	158±3	8.0(1/2")	4.2	>220	±28.2@F11	<0.1	<0.1	337±3	161.2	C	0.8
DTCM120-72-AL	72	0.111	178±3	8.0(1/2")	4.2	>215	±35.7@F11	<0.1	<0.1	377±3	181.2	C	1.0
DTCM120-80H-AL	80	0.100	228±4	8.0(1/2")	4.2	>210	±44@F11	<0.1	<0.1	417±4	171.2	C	1.8
DTCM120-90-AL	90	0.089	208±3	8.0(1/2")	4.2	>210	±55.5@F11	<0.1	<0.1	432±3	206.2	C	1.6
DTCM120-100-AL	100	0.080	258±4	8.0(1/2")	4.2	>210	±68.7@F11	<0.1	<0.1	505±4	229.6	C	3.0
DTCM120-110-AL	110	0.073	263±4	8.0(1/2")	4.2	>210	±82.6@F11	<0.1	<0.1	539±4	258.8	C	2.6
DTCM120-120-AL	120	0.067	280±5	8.0(1/2")	4.2	>210	±98@F11	<0.1	<0.1	569±5	271.1	C	4.1
DTCM120-136-AL	136	0.059	288±5	8.0(1/2")	4.2	>215	±126@F11	<0.1	<0.1	649±5	343.8	C	-
DTCM120-150-AL	150	0.053	300±5	8.0(1/2")	4.2	>210	±156@F11	<0.1	<0.1	631±5	313.2	C	5.6
DTCM120-170-AL	170	0.047	318±5	8.0(1/2")	4.2	>210	±199@F11	<0.1	<0.1	711±5	375.1	C	6.4
DTCM120-190-AL	190	0.042	330±5	8.0(1/2")	4.2	>210	±249@F11	<0.1	<0.1	750±5	402.5	C	11.0
DTCM120-216-AL	216	0.037	372±5	8.0(1/2")	4.2	>210	±321@F11	<0.1	<0.1	887±5	497.9	C	13.7
DTCM120-240H-AL	240	0.033	410±6	8.0(1/2")	4.2	>210	±397@F11	<0.1	<0.1	971±6	543.8	C	19.2
DTCM120-268-AL	268	0.030	438±6	8.0(1/2")	4.2	>210	±489@F11	<0.1	<0.1	1087±6	631.3	C	-
DTCM120-300-AL	300	0.027	465±6	8.0(1/2")	4.2	>205	±603@F11	<0.1	<0.1	1105±6	622.2	C	46.5

## DTCM120-26-AL

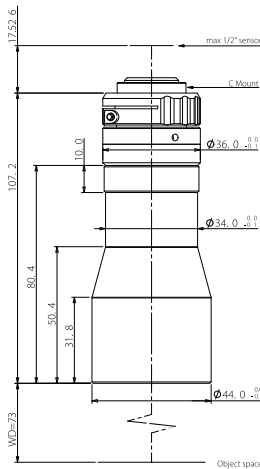

FOV(Φmm)	26
Mag.(x)	0.308
WD(mm)	73±1
Max Sensor Size(Φmm)	8.0(1/2")
F/#	4.2
MTF30(lp/mm)	>175
DOF(mm)	±4.6@F11
Distortion(% max)	<0.1
Telecentricity(° max)	<0.1
I/O(mm)	198±1
Length(mm)	107.2
Mount	C-Mount
Weight(kg)	0.3
Field of View (mmxmm)	
1/2.3" 9J003	6.44x4.62 20.9x15.0

## DTCM120-36-AL

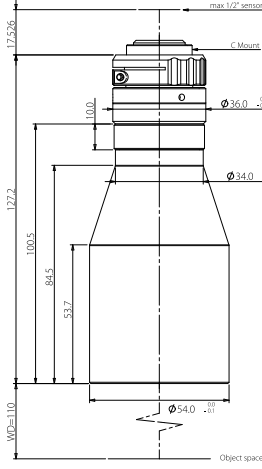

FOV(Φmm)	36
Mag.(x)	0.222
WD(mm)	110±2
Max Sensor Size(Φmm)	8.0(1/2")
F/#	4.2
MTF30(lp/mm)	>190
DOF(mm)	±8.9@F11
Distortion(% max)	<0.1
Telecentricity(° max)	<0.1
I/O(mm)	255±2
Length(mm)	127.2
Mount	C-Mount
Weight(kg)	0.4
Field of View (mmxmm)	
1/2.3" 9J003	6.44x4.62 29.0x20.8

## DTCM120-42-AL

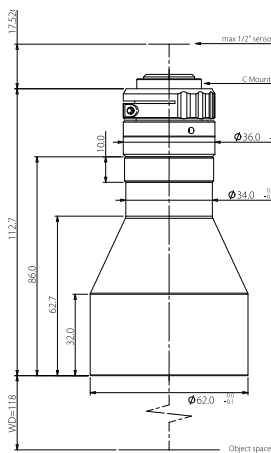

FOV(Φmm)	42
Mag.(x)	0.190
WD(mm)	118±3
Max Sensor Size(Φmm)	8.0(1/2")
F/#	4.2
MTF30(lp/mm)	>210
DOF(mm)	±12.1@F11
Distortion(% max)	<0.1
Telecentricity(° max)	<0.1
I/O(mm)	248±3
Length(mm)	112.7
Mount	C-Mount
Weight(kg)	0.4
Field of View (mmxmm)	
1/2.3" 9J003	6.44x4.62 33.9x24.3

## DTCM120-48-AL

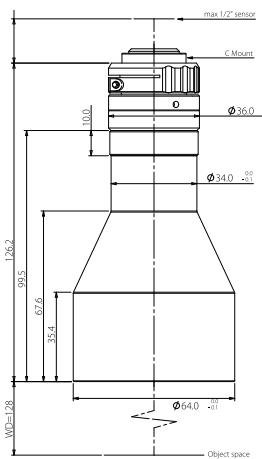

FOV(Φmm)	48
Mag.(x)	0.167
WD(mm)	128±3
Max Sensor Size(Φmm)	8.0(1/2")
F/#	4.2
MTF30(lp/mm)	>200
DOF(mm)	±15.7@F11
Distortion(% max)	<0.1
Telecentricity(° max)	<0.1
I/O(mm)	272±3
Length(mm)	126.2
Mount	C-Mount
Weight(kg)	0.4
Field of View (mmxmm)	
1/2.3" 9J003	6.44x4.62 38.6x27.7

## DTCM120-56-AL

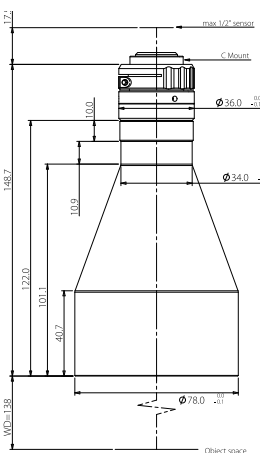

FOV(Φmm)	56
Mag.(x)	0.143
WD(mm)	138±3
Max Sensor Size(Φmm)	8.0(1/2")
F/#	4.2
MTF30(lp/mm)	>210
DOF(mm)	±21.5@F11
Distortion(% max)	<0.1
Telecentricity(° max)	<0.1
I/O(mm)	304±3
Length(mm)	148.7
Mount	C-Mount
Weight(kg)	0.6
Field of View (mmxmm)	
1/2.3" 9J003	6.44x4.62 45.0x32.3

## DTCM120-64H-AL

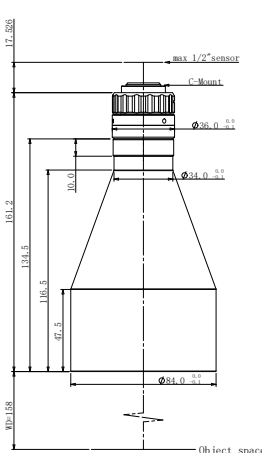

FOV(Φmm)	64
Mag.(x)	0.125
WD(mm)	158±3
Max Sensor Size(Φmm)	8.0(1/2")
F/#	4.2
MTF30(lp/mm)	>220
DOF(mm)	±28.2@F11
Distortion(% max)	<0.1
Telecentricity(° max)	<0.1
I/O(mm)	337±3
Length(mm)	161.2
Mount	C-Mount
Weight(kg)	0.8
Field of View (mmxmm)	
1/2.3" 9J003	6.44x4.62 51.5x37.0

## DTCM120-72-AL

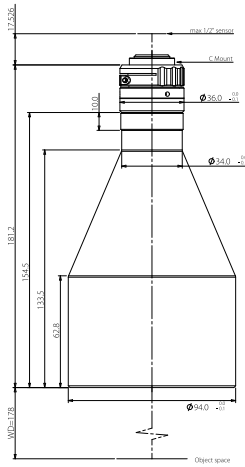

FOV(Φmm)	72
Mag.(x)	0.111
WD(mm)	178 ± 3
Max Sensor Size(Φmm)	8.0(1/2")
F/#	4.2
MTF30(lp/mm)	>215
DOF(mm)	± 35.7@F11
Distortion(% max)	<0.1
Telecentricity(° max)	<0.1
I/O(mm)	377 ± 3
Length(mm)	181.2
Mount	C-Mount
Weight(kg)	1.0
Field of View (mmxmm)	
1/2.3" 9J003	6.44x4.62 58.0x41.6

## DTCM120-80H-AL

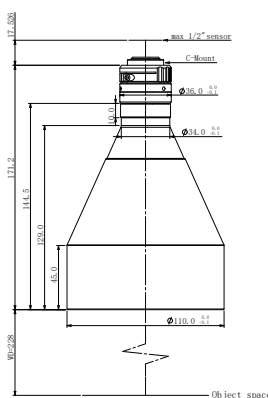

FOV(Φmm)	80
Mag.(x)	0.100
WD(mm)	228 ± 4
Max Sensor Size(Φmm)	8.0(1/2")
F/#	4.2
MTF30(lp/mm)	>210
DOF(mm)	± 44@F11
Distortion(% max)	<0.1
Telecentricity(° max)	<0.1
I/O(mm)	417 ± 4
Length(mm)	171.2
Mount	C-Mount
Weight(kg)	1.8
Field of View (mmxmm)	
1/2.3" 9J003	6.44x4.62 64.4x46.2

## DTCM120-90-AL

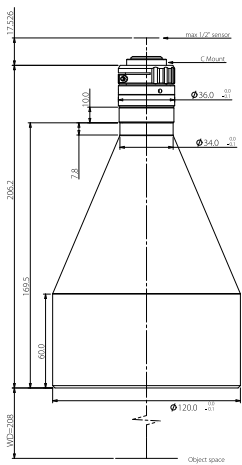

FOV(Φmm)	90
Mag.(x)	0.089
WD(mm)	208 ± 3
Max Sensor Size(Φmm)	8.0(1/2")
F/#	4.2
MTF30(lp/mm)	>210
DOF(mm)	± 55.5@F11
Distortion(% max)	<0.1
Telecentricity(° max)	<0.1
I/O(mm)	432 ± 3
Length(mm)	206.2
Mount	C-Mount
Weight(kg)	1.6
Field of View (mmxmm)	
1/2.3" 9J003	6.44x4.62 72.4x51.9

## DTCM120-100-AL

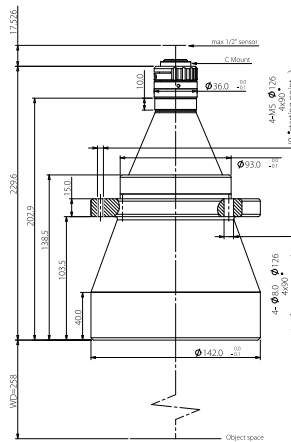

FOV(Φmm)	100
Mag.(x)	0.080
WD(mm)	258 ± 4
Max Sensor Size(Φmm)	8.0(1/2")
F/#	4.2
MTF30(lp/mm)	>210
DOF(mm)	± 68.7@F11
Distortion(% max)	<0.1
Telecentricity(° max)	<0.1
I/O(mm)	505 ± 4
Length(mm)	229.6
Mount	C-Mount
Weight(kg)	3.0
Field of View (mmxmm)	
1/2.3" 9J003	6.44x4.62 80.5x57.8

## DTCM120-110-AL

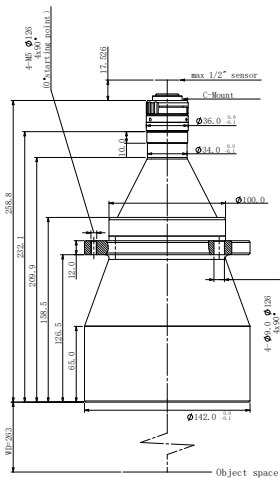

FOV(Φmm)	110
Mag.(x)	0.073
WD(mm)	263 ± 4
Max Sensor Size(Φmm)	8.0(1/2")
F/#	4.2
MTF30(lp/mm)	>210
DOF(mm)	± 82.6@F11
Distortion(% max)	<0.1
Telecentricity(° max)	<0.1
I/O(mm)	539 ± 4
Length(mm)	258.8
Mount	C-Mount
Weight(kg)	2.6
Field of View (mmxmm)	
1/2.3" 9J003	6.44x4.62 88.2x63.3

## DTCM120-120-AL

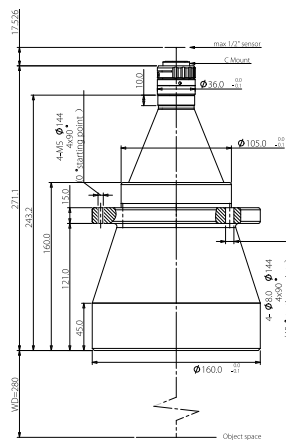

FOV(Φmm)	120
Mag.(x)	0.067
WD(mm)	280 ± 5
Max Sensor Size(Φmm)	8.0(1/2")
F/#	4.2
MTF30(lp/mm)	>210
DOF(mm)	± 98@F11
Distortion(% max)	<0.1
Telecentricity(° max)	<0.1
I/O(mm)	569 ± 5
Length(mm)	271.1
Mount	C-Mount
Weight(kg)	4.1
Field of View (mmxmm)	
1/2.3" 9J003	6.44x4.62 96.1x69.0

### DTCM120-136-AL

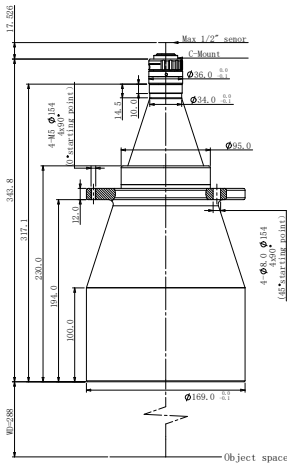

FOV(Φmm)	136
Mag.(x)	0.059
WD(mm)	288±5
Max Sensor Size(Φmm)	8.0(1/2")
F/#	4.2
MTF30(lp/mm)	>215
DOF(mm)	±126@F11
Distortion(% max)	<0.1
Telecentricity(° max)	<0.1
I/O(mm)	649±5
Length(mm)	343.8
Mount	C-Mount
Weight(kg)	-
Field of View (mmxmm)	1/2.3" 9J003 6.44x4.62 109.2x78.3

### DTCM120-150-AL

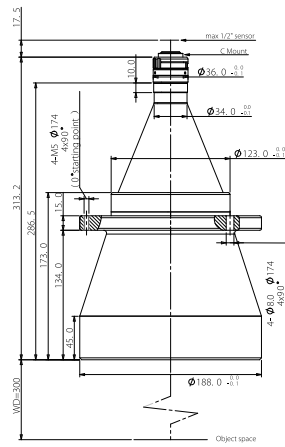

FOV(Φmm)	150
Mag.(x)	0.053
WD(mm)	300±5
Max Sensor Size(Φmm)	8.0(1/2")
F/#	4.2
MTF30(lp/mm)	>210
DOF(mm)	±156@F11
Distortion(% max)	<0.1
Telecentricity(° max)	<0.1
I/O(mm)	631±5
Length(mm)	313.2
Mount	C-Mount
Weight(kg)	5.6
Field of View (mmxmm)	1/2.3" 9J003 6.44x4.62 121.5x87.2

### DTCM120-170-AL

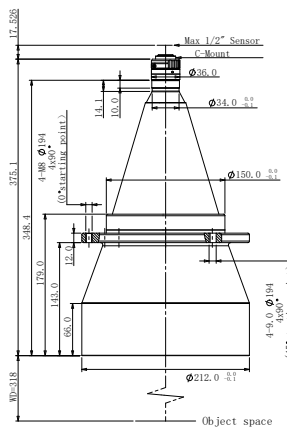

FOV(Φmm)	170
Mag.(x)	0.047
WD(mm)	318±5
Max Sensor Size(Φmm)	8.0(1/2")
F/#	4.2
MTF30(lp/mm)	>210
DOF(mm)	±199@F11
Distortion(% max)	<0.1
Telecentricity(° max)	<0.1
I/O(mm)	711±5
Length(mm)	375.1
Mount	C-Mount
Weight(kg)	6.4
Field of View (mmxmm)	1/2.3" 9J003 6.44x4.62 137.0x98.3

### DTCM120-190-AL

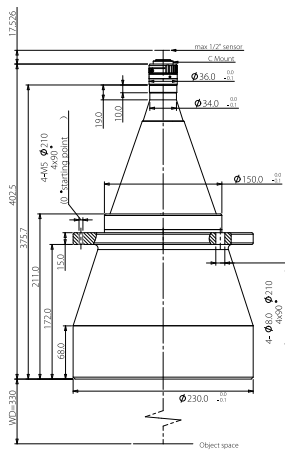

FOV(Φmm)	190
Mag.(x)	0.042
WD(mm)	330±5
Max Sensor Size(Φmm)	8.0(1/2")
F/#	4.2
MTF30(lp/mm)	>210
DOF(mm)	±249@F11
Distortion(% max)	<0.1
Telecentricity(° max)	<0.1
I/O(mm)	750±5
Length(mm)	402.5
Mount	C-Mount
Weight(kg)	11.0
Field of View (mmxmm)	1/2.3" 9J003 6.44x4.62 153.3x110.0

### DTCM120-216-AL

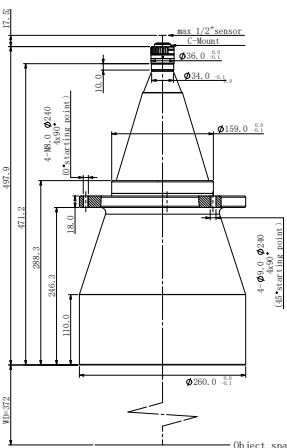

FOV(Φmm)	216
Mag.(x)	0.037
WD(mm)	372±5
Max Sensor Size(Φmm)	8.0(1/2")
F/#	4.2
MTF30(lp/mm)	>210
DOF(mm)	±321@F11
Distortion(% max)	<0.1
Telecentricity(° max)	<0.1
I/O(mm)	887±5
Length(mm)	497.9
Mount	C-Mount
Weight(kg)	13.7
Field of View (mmxmm)	1/2.3" 9J003 6.44x4.62 174.1x124.9

### DTCM120-240H-AL

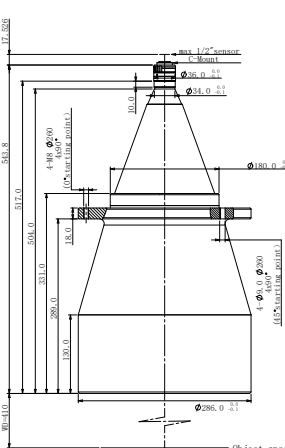

FOV(Φmm)	240
Mag.(x)	0.033
WD(mm)	410±6
Max Sensor Size(Φmm)	8.0(1/2")
F/#	4.2
MTF30(lp/mm)	>210
DOF(mm)	±397@F11
Distortion(% max)	<0.1
Telecentricity(° max)	<0.1
I/O(mm)	971±6
Length(mm)	543.8
Mount	C-Mount
Weight(kg)	19.2
Field of View (mmxmm)	1/2.3" 9J003 6.44x4.62 195.2x140.0

## DTCM120-268-AL

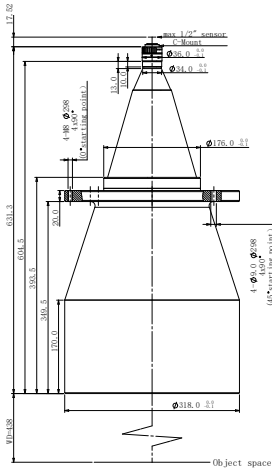

FOV(Φmm)	268
Mag.(x)	0.030
WD(mm)	438±6
Max Sensor Size(Φmm)	8.0(1/2")
F/#	4.2
MTF30(lp/mm)	>210
DOF(mm)	±489@F11
Distortion(% max)	<0.1
Telecentricity(° max)	<0.1
I/O(mm)	1087±6
Length(mm)	631.3
Mount	C-Mount
Weight(kg)	-

### Field of View (mmxmm)

1/2.3" 9J003	6.44x4.62	214.7x154.0
--------------	-----------	-------------

## DTCM120-300-AL

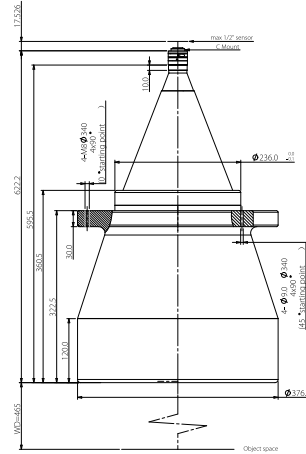

FOV(Φmm)	300
Mag.(x)	0.027
WD(mm)	465±6
Max Sensor Size(Φmm)	8.0(1/2")
F/#	4.2
MTF30(lp/mm)	>205
DOF(mm)	±603@F11
Distortion(% max)	<0.1
Telecentricity(° max)	<0.1
I/O(mm)	1105±6
Length(mm)	622.2
Mount	C-Mount
Weight(kg)	46.5

### Field of View (mmxmm)

1/2.3" 9J003	6.44x4.62	238.5x171.1
--------------	-----------	-------------